



# LOWER WESTPORT

WAREHAM, DORSET



Distinctive new homes in one of Dorset's most charming old towns

*Fry*

## NEW HOMES WITH A TRADITIONAL FEEL

C G Fry & Son's small development at Lower Westport, Wareham, offers an exceptional chance to acquire a new home in one of Dorset's most appealing small towns.

At Lower Westport, by the River Frome and a short walk from the centre of town, Frys are constructing just 11 distinctive homes on a gently-sloping site facing south towards the Purbeck Hills, with glimpses of the river and Corfe Castle.

## A REPUTATION BUILT ON QUALITY

Frys' reputation has been built on quality of design and construction, and Lower Westport is one of the company's hallmark smaller developments. Built with a traditional approach using brick and render, the houses are designed to sit comfortably alongside the ancient town's older buildings, but modern thinking and new techniques mean 21st century standards of energy-efficiency, comfort and security.

## NATURAL CHOICES FROM C G FRY & SON

A number of the homes are solar-ready, meaning that solar panels can be easily installed, and two go even greener, featuring a 'living roof' of sedum. Some feature Frys' Premier Plus specification which includes upgraded bathroom and kitchen fittings, granite work surfaces and more extensive tiling and trim.

All reflect the quality and attention to detail that buyers have come to expect in a C G Fry & Son home.



  
LOWER WESTPORT

## HISTORY AND CHARM

Wareham (Anglebury in the novels of Thomas Hardy) is one of the most charming towns in Dorset, in a corner of the county full of natural beauty and historical interest.

Earth walls from Saxon times enclose the town's old centre – a legacy of the days when it was a stronghold for Alfred the Great. Streets of Georgian cottages ramble down to the riverside, which was a major port until the Middle Ages, when sea trade found a new focus downstream at Poole.



Wareham is packed with independent shops, cafes and galleries, and has a famous small cinema still lit by gas until very recently. But the area is also well connected. Big-town shopping and entertainment is easy by train – around 11 minutes to Poole and less than 25 minutes to Bournemouth. Airports at Bournemouth and Southampton and the proximity of the M27 mean that the wider world is not far away.

Parents with school-age children will find that primary, middle and secondary education is all catered for in Wareham, and this part of Dorset also offers a number of independent schools. At further education level a wide range of opportunities at Bournemouth and Southampton is in easy reach by train.



## GLORIOUS PURBECK

Trains with a difference run on the old branch line from from nearby Norden to the seaside town of Swanage: the steam trains of the famous Swanage Railway, which take passengers in vintage style through the glorious corner of Dorset known as the Isle of Purbeck.



Sailing and watersports enthusiasts will be in their element in this part of the south coast, as will walkers, cyclists and history buffs, with prime local landmarks including Corfe Castle and the cottage at Clouds Hill which was the modest home of T E Lawrence (Lawrence of Arabia).

## CARE AND FLAIR FROM C G FRY

Craftsmanship and quality have always been the hallmarks of C G Fry & Son's work, marrying traditional workmanship with the best of contemporary building techniques.

The Dorset company has always set out to build individual homes in harmony with existing local architecture and featuring local materials.

Fry's major part in the building of Prince Charles's Poundbury development at Dorchester has created a world showcase for the company's design and excellence of finish. The focus, however, remains firmly on the excellence of each new home.



As ever, the emphasis is on sympathetic design, quality materials and attention to detail by craftsmen working in the traditional way.

More information about Lower Westport as well as our other developments throughout the southwest can be found online at [www.cgfry.co.uk](http://www.cgfry.co.uk)

  
LOWER WESTPORT

# LOWER WESTPORT

Wareham, Dorset BH20 4FE

For property details at Lower Westport contact  
Annabel Ford, at Poundbury Sales Office,  
Bridport Road, Dorchester, DT1 3BN  
Telephone: 01305 259600  
E-mail: poundburysales@cgfry.co.uk



## C. G. FRY & SON

...history, reputation and vision

C. G. Fry & Son Ltd.  
Litton Cheney Dorchester Dorset DT2 9AS  
Tel: 01308 482000 Fax: 01308 482249  
E-mail: sales@cgfry.co.uk  
website: www.cgfry.co.uk

Members of NHBC

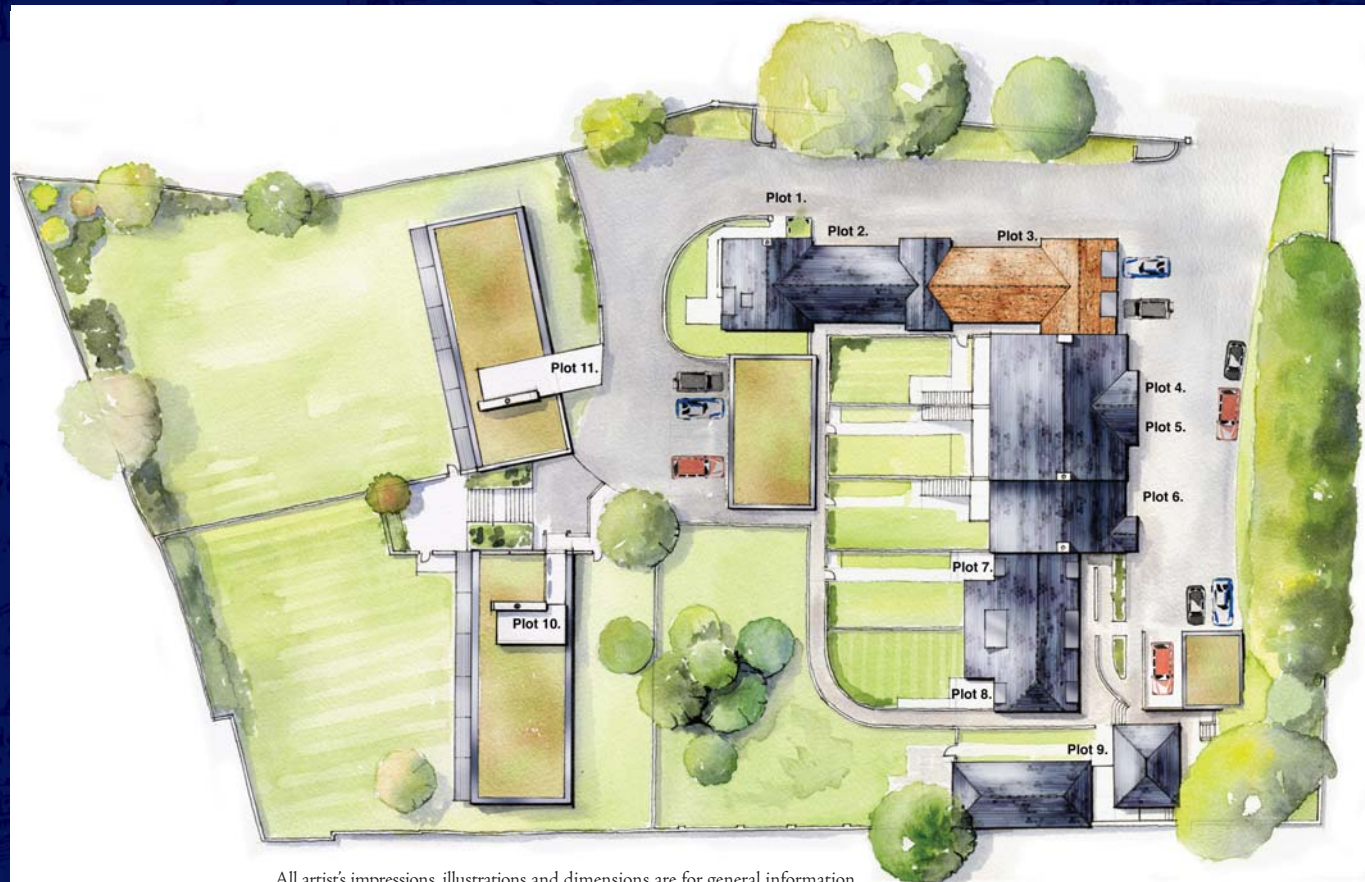

All artists impressions, illustrations and dimensions are for general information only and do not form part of any contract. Wall and roof finishes and window details may be subject to alteration during construction. Accordingly purchasers should satisfy themselves as to specific plot details with our sales staff.